

SHEET 1: COVER SHEET

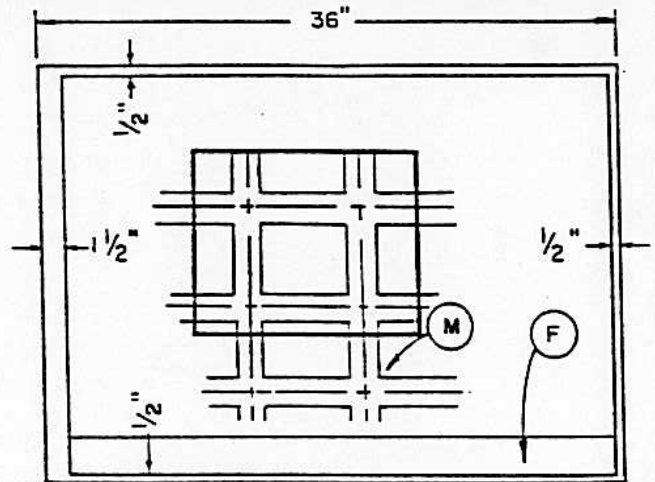

SHEET 2: MASTER PLAN LAYOUT SHEETS
AND SUBSEQUENT SHEETS AS NECESSARY
MASTER GRADING, STREET SIGN AND LIGHTING PLAN
MASTER WATER, SEWER AND STORM DRAINAGE PLAN

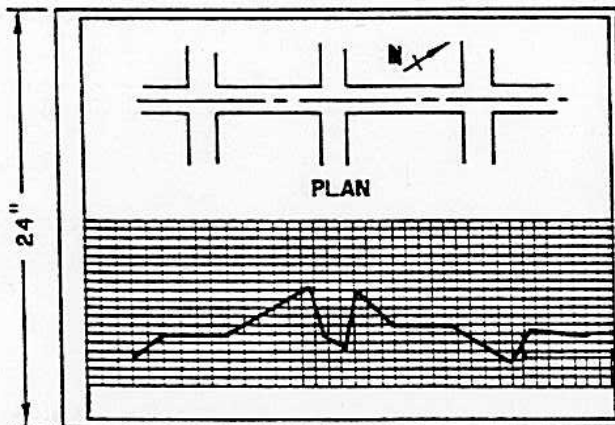

SHEET 3: PLAN AND PROFILE SHEETS
AND SUBSEQUENT SHEETS AS NECESSARY
(HORIZONTAL SCALE: 1"=20' TO 1"=40')

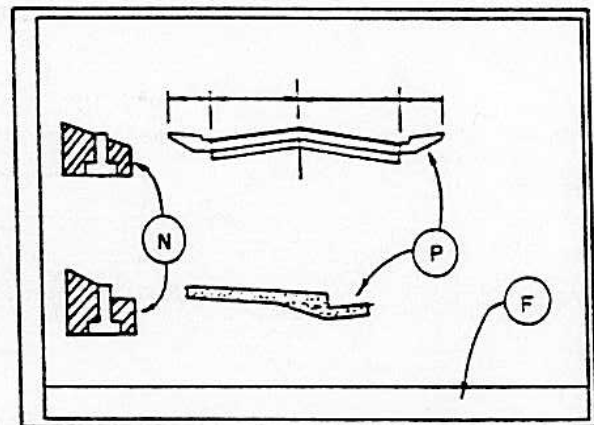

REMAINING SHEETS
DETAILS FOR TYPICAL OR
SPECIAL CONSTRUCTION

LEGEND

- | | | |
|--------------------------------|--------------------------|---------------------------|
| A. PROJECT TITLE AND TRACT NO. | F. TITLE BLOCK | K. S.S.J.I.D. DISCLAIMER |
| B. INDEX OF SHEETS | G. STREET SIGN INDEX | L. CITY DISCLAIMER |
| C. BENCH MARK DATA | H. PAVEMENT DESIGN CHART | M. ROAD APPROACHES |
| D. LEGEND | I. VICINITY MAP | N. EARTHWORK DETAILS |
| E. ABBREVIATIONS | J. CONSTRUCTION NOTES | P. TYPICAL CROSS SECTIONS |

NOTES:

- 1) ALL SHEETS SHALL BE SIGNED AND STAMPED BY A REGISTERED CIVIL ENGINEER PRIOR TO SUBMITTAL TO THE CITY.
- 2) THE S.S.J.I.D. AND CITY DISCLAIMER SHALL APPEAR ON ALL SHEETS.

NO.	REVISED	BY
1	JAN. 1988	JK
DRAWN BY: C. SABERTON		
CHECKED BY: J. PODESTA		
SCALE: NONE		

STANDARD LAYOUT FOR
IMPROVEMENT PLANS

CITY OF MANTECA
DEPARTMENT OF PUBLIC WORKS

APPROVED BY:
M. J. Britton
DIRECTOR OF PUBLIC WORKS

DRAWING NO. **E-1**
DATE: JAN. 1988

LEGEND

TO BE CONST.

DESCRIPTION

EXISTING



PROPERTY LINE



CENTER LINE



SECTION LINE

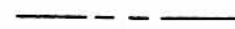

EDGE OF PAVEMENT

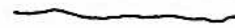

LIMIT OF WORK LINE



CITY LIMIT LINE

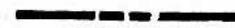

CURB, GUTTER, AND SIDEWALK
WITH WHEELCHAIR RAMP

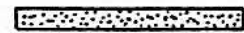
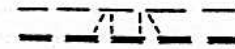

AGGREGATE BASE



SURVEY MONUMENT



TYPE "A" BARRICADE

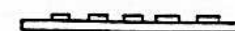

TYPE "B" BARRICADE

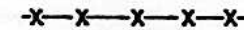

FENCE



RAILROAD TRACKS



GUARD RAIL



ELECTROLIER

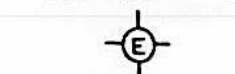

UTILITY POLE

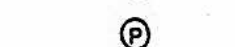

TELEPHONE CABLE



CABLE TELEVISION



NO.	REVISED	BY
I	JAN. 1988	JK
DRAWN BY: C. SABERTON		
CHECKED BY: J. PODESTA		
SCALE: NONE		

STANDARD DRAFTING SYMBOLS

CITY OF MANTECA
DEPARTMENT OF PUBLIC WORKS

APPROVED BY:

M. Briston
DIRECTOR OF PUBLIC WORKS

DRAWING NO.

DATE: JAN. 1988

E-2

LEGEND

TO BE CONST.

DESCRIPTION

EXISTING

	WATER LINE	
	WATER VALVE	
	WATER BLOW OFF	
	FIRE HYDRANT	
	WATER SERVICE	
	WATER METER	
	SEWER LINE	
	SANITARY MANHOLE	
	SANITARY MAIN CLEAN OUT	
	SEWER LATERAL	
	STORM DRAIN LINE	
	STORM MANHOLE	
	CURB INLET OR CATCH BASIN	
	GAS LINE	
	GAS VALVE	

NO.	REVISED	BY	STANDARD DRAFTING SYMBOLS	APPROVED BY: DIRECTOR OF PUBLIC WORKS
DRAWN BY: J. KOESTER				CITY OF MANTECA DEPARTMENT OF PUBLIC WORKS
CHECKED BY: J. PODESTA				
SCALE: NONE			DRAWING NO. E-3	DATE: JAN. 1988

1. CONTRACTOR AGREES THAT HE SHALL ASSUME SOLE AND COMPLETE RESPONSIBILITY FOR JOB SITE CONDITIONS DURING THE COURSE OF CONSTRUCTION OF THIS PROJECT, INCLUDING SAFETY OF ALL PERSONS AND PROPERTY; THAT THIS REQUIREMENT SHALL APPLY CONTINUOUSLY AND NOT BE LIMITED TO NORMAL WORKING HOURS; AND THAT THE CONTRACTOR SHALL DEFEND, INDEMNIFY AND HOLD THE OWNER, ENGINEER AND THE CITY HARMLESS FROM ANY AND ALL LIABILITY, REAL OR ALLEGED, IN CONNECTION WITH THE PERFORMANCE OF WORK ON THIS PROJECT, EXCEPTING FOR LIABILITY ARISING FROM THE SOLE NEGLIGENCE OF THE OWNER OR THE ENGINEER.
2. UNLESS OTHERWISE STATED, ALL STATIONS INDICATED ON THE IMPROVEMENT PLANS ARE REFERENCED TO THE CENTER LINE OF THE STREET. ALL STATIONS ON THE CURBS ARE PERPENDICULAR TO OR RADIALLY OPPOSITE CENTER LINE STATIONS, UNLESS OTHERWISE NOTED.
3. IT IS THE CONTRACTOR'S RESPONSIBILITY TO VERIFY THE LOCATION OF ALL EXISTING FACILITIES.
4. THE CONTRACTOR SHALL BE HELD RESPONSIBLE FOR ANY FIELD CHANGES MADE WITHOUT WRITTEN AUTHORIZATION FROM THE CITY ENGINEER.
5. THE CONTRACTOR SHALL PROVIDE ALL LIGHTS, SIGNS, BARRICADES, FLAGMEN OR OTHER DEVICES NECESSARY TO PROVIDE FOR PUBLIC SAFETY IN ACCORDANCE WITH THE CURRENT ISSUE OF "MANUAL OF TRAFFIC CONTROLS WARNING SIGNS, LIGHTS AND DEVICES FOR USE IN PERFORMANCE OF WORK UPON HIGHWAYS" PUBLISHED BY THE STATE OF CALIFORNIA BUSINESS AND TRANSPORTATION AGENCY.
6. CONTRACTOR SHALL BE RESPONSIBLE FOR ADEQUATELY MARKING THE INSTALLED LOCATION OF ALL SANITARY AND WATER SERVICES (STAMPED WITH AN "S" AND "W" RESPECTIVELY) AT THE TIME OF INSTALLATION. CONTRACTOR SHALL REMOVE ALL EXISTING BERMS, STRUCTURES AND BARRICADES, PAVING AND/OR OIL SCREENINGS WITHIN SPECIFIC AREAS INDICATED TO BE IMPROVED.
7. THE OFFICE OF THE CITY ENGINEER SHALL BE NOTIFIED AT LEAST 24 HOURS IN ADVANCE OF ANY WORK.
8. ALL MATERIALS, WORKMANSHIP, AND CONSTRUCTION SHALL BE DONE IN ACCORDANCE WITH THE REQUIREMENTS OF THE CITY OF MANTECA, DEPARTMENT OF PUBLIC WORKS STANDARD PLANS AND SPECIFICATIONS; AND THE LATEST EDITION OF THE STATE OF CALIFORNIA, DEPARTMENT OF TRANSPORTATION, STANDARD SPECIFICATIONS.
9. P.G.&E., TELEPHONE AND CABLE TV UNDERGROUND WORK SHALL BE COMPLETED PRIOR TO CONSTRUCTION OF THE CURB, GUTTER, SIDEWALK AND PAVING.
10. IF REQUIRED, THE CONTRACTOR SHALL DETERMINE THE PROPER WELL PLACEMENTS TO ADEQUATELY DEWATER THE AREA FOR TRENCHING.

NO.	REVISED	BY	GENERAL NOTES	APPROVED BY:
1	JAN. 1988	JK		<i>M. B. Buntin</i> DIRECTOR OF PUBLIC WORKS
DRAWN BY: J. HULSEY			CITY OF MANTECA DEPARTMENT OF PUBLIC WORKS	DRAWING NO. E-4
CHECKED BY: J. PODESTA				DATE: JAN. 1988
SCALE: NONE				

11. THE CITY OF MANTECA OR ASSOCIATED UTILITY COMPANY AND RESIDENCES TO BE AFFECTED SHALL BE NOTIFIED IMMEDIATELY UPON ANY UTILITY SERVICE DISRUPTION OTHER THAN SPECIFIED ON THESE IMPROVEMENT PLANS AND A 24 HOUR NOTICE SHALL BE GIVEN FOR ANY PLANNED DISRUPTION.
12. DUST SHALL BE CONTROLLED AS PER SECTION 10 OF THE STATE OF CALIFORNIA, DEPARTMENT OF TRANSPORTATION, STANDARD SPECIFICATIONS AND THE CITY OF MANTECA'S SPECIFICATIONS.
13. LOTS SHALL BE GRADED TO ESTABLISH IDENTICAL ELEVATIONS (MATCH GRADES) WITH ADJACENT LOTS AND SURROUNDING PROPERTY UNLESS OTHERWISE APPROVED BY THE CITY ENGINEER.
14. AN ENCROACHMENT PERMIT SHALL BE OBTAINED FROM THE CITY OF MANTECA, DEPARTMENT OF PUBLIC WORKS OR ANY OTHER APPLICABLE AGENCIES PRIOR TO COMMENCEMENT OF WORK WITHIN EXISTING CITY RIGHT-OF-WAY.
15. STREET SIGNS, TRAFFIC CONTROL SIGNS, AND PAVEMENT MARKINGS SHALL BE PROVIDED AND INSTALLED BY THE CONTRACTOR AT LOCATIONS ESTABLISHED BY THE CITY ENGINEER.
16. THE CONTRACTOR SHALL SECURE A TRENCH PERMIT FROM THE CALIFORNIA DIVISION OF INDUSTRIAL SAFETY PRIOR TO EXCAVATION OF ANY TRENCH OVER FIVE FEET IN DEPTH.
17. ASPHALT CONCRETE SHALL BE PLACED ONLY WHEN THE ATMOSPHERIC TEMPERATURE IS ABOVE 50°F.
18. ALL STREET LIGHTING SHALL BE CONSTRUCTED BY AND AT A COST TO THE DEVELOPER SUCH THAT OWNERSHIP OF THE STREET LIGHTS ARE TO BE PROVIDED TO THE CITY (LS-2C SCHEDULE).
19. THE CONTRACTOR SHALL VERIFY LOCATIONS OF ALL EXISTING UNDERGROUND UTILITIES AND SHALL CONTACT THE RESPECTIVE UTILITY COMPANIES PRIOR TO COMMENCEMENT OF WORK. HE SHALL BE RESPONSIBLE FOR THE LOCATION AND PRESERVATION OF ALL SUCH FACILITIES IN THE AREA OF CONSTRUCTION AND SHALL NOTIFY UTILITIES FORTY-EIGHT (48) HOURS IN ADVANCE OF ANY CONSTRUCTION.
20. CONTRACTOR IS RESPONSIBLE FOR COORDINATION OF THE REMOVAL OR RELOCATION OF ALL EXISTING UTILITIES WITH RESPECTIVE UTILITY COMPANIES.
21. THE CONTRACTOR IS TO PROVIDE COMPACTED BUILDING PADS AT THE ELEVATIONS SHOWN ON THE GRADING PLAN.
22. ALL SERVICE LATERALS SHALL BE EXTENDED PAST THE PROPERTY LINE AND PLUGGED.

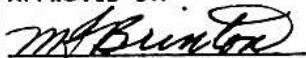
NO.	REVISED	BY	GENERAL NOTES	APPROVED BY:
2	11/7/88	JK		
DRAWN BY: J. HULSEY				DIRECTOR OF PUBLIC WORKS
CHECKED BY: J. PODESTA				DRAWING NO. E-5
SCALE: NONE			CITY OF MANTECA DEPARTMENT OF PUBLIC WORKS	DATE: JAN. 1988

23. MANHOLE CASTINGS AND COVERS SHALL BE ADJUSTED TO FINAL GRADES BY THE PAVING CONTRACTOR AFTER STREET IMPROVEMENTS ARE COMPLETED.
24. ALL WATER LINES SHALL BE TESTED AND DISINFECTED IN COMPLIANCE WITH THE REQUIREMENTS OF THE CITY OF MANTECA'S STANDARD PLANS AND SPECIFICATIONS, PRIOR TO FINAL ACCEPTANCE.
25. AFTER CONSTRUCTION OF ALL IMPROVEMENTS, THE ENGINEER SHALL SUBMIT ONE SET OF REPRODUCIBLE "AS BUILT" PLANS. FINAL INVERT ELEVATIONS FOR SEWER AND STORM DRAIN LINES THAT ARE TO BE EXTENDED FOR FUTURE CONSTRUCTION SHALL ALSO BE SHOWN ON THE "AS BUILT" PLANS.
26. ALL TRENCHES ON MAJOR AND COLLECTOR STREETS AND CROSS TRENCHES ON ALL STREETS SHALL BE PAVED WITH TEMPORARY PAVING THE SAME DAY THE PAVEMENT CUT IS MADE.
27. CONTRACTOR SHALL PROVIDE CITY WITH A CERTIFICATE SIGNED BY A REGISTERED CIVIL ENGINEER STATING THAT ALL BUILDING PAD ELEVATIONS ARE IN CONFORMANCE WITH APPROVED GRADING PLAN.

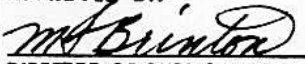
NO.	REVISED	BY	GENERAL NOTES	APPROVED BY:
1	JAN. 1988	JK		 DIRECTOR OF PUBLIC WORKS
DRAWN BY: J. HULSEY			CITY OF MANTECA DEPARTMENT OF PUBLIC WORKS	DRAWING NO. E-6
CHECKED BY: J. PODESTA				DATE: JAN. 1988
SCALE: NONE				

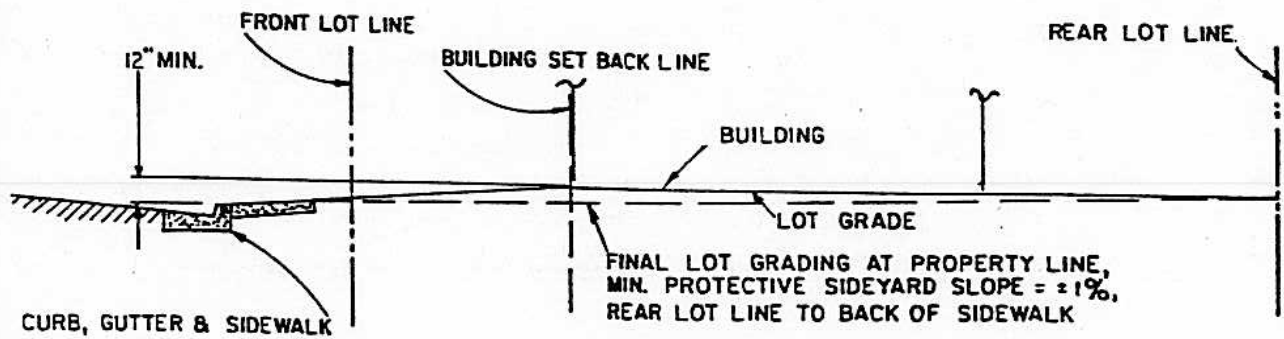
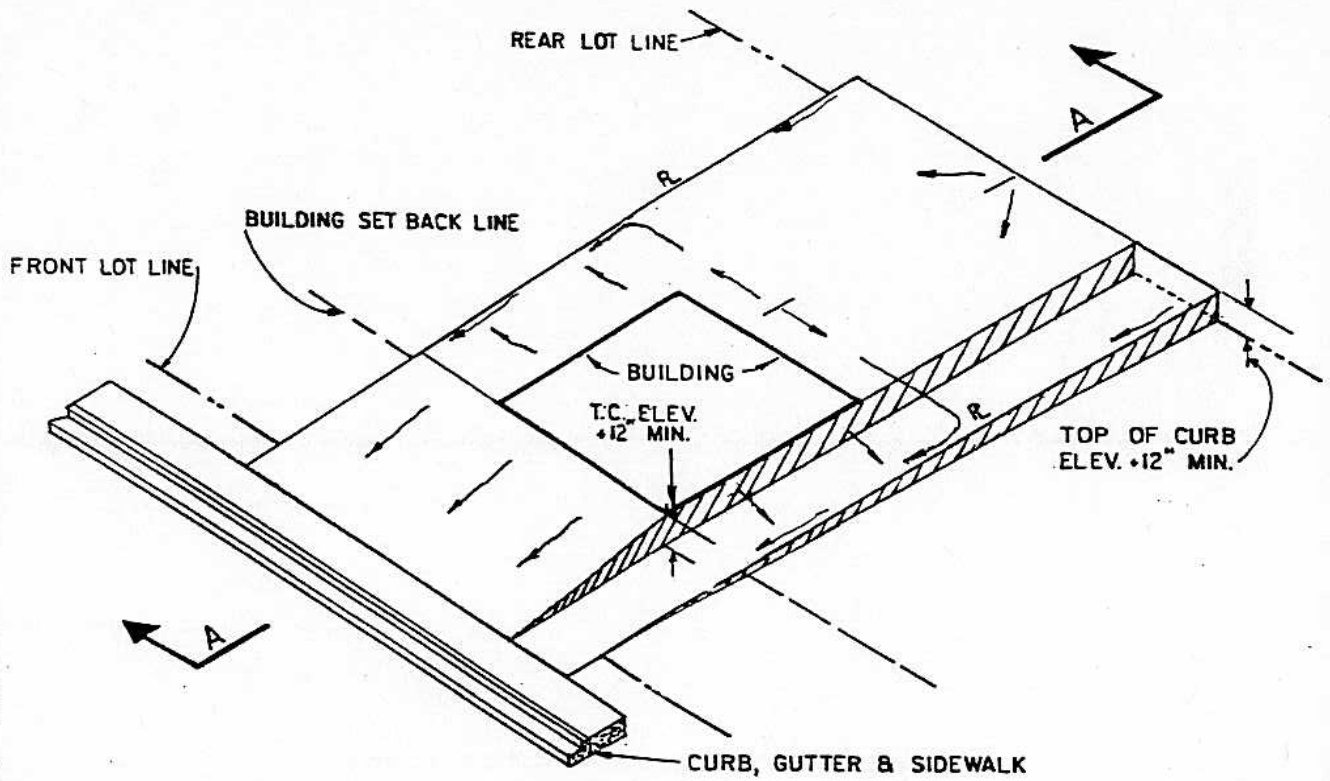

SECTION A-A

NO.	REVISED	BY
1	JAN. 1988	JK
DRAWN BY: J. MENDOZA		
CHECKED BY: J. PODESTA		
SCALE: NONE		

TYPICAL LOT GRADING DETAIL

CITY OF MANTECA
DEPARTMENT OF PUBLIC WORKS

APPROVED BY:
M. Brinton
DIRECTOR OF PUBLIC WORKS

DRAWING NO.
DATE: JAN. 1988

E-7

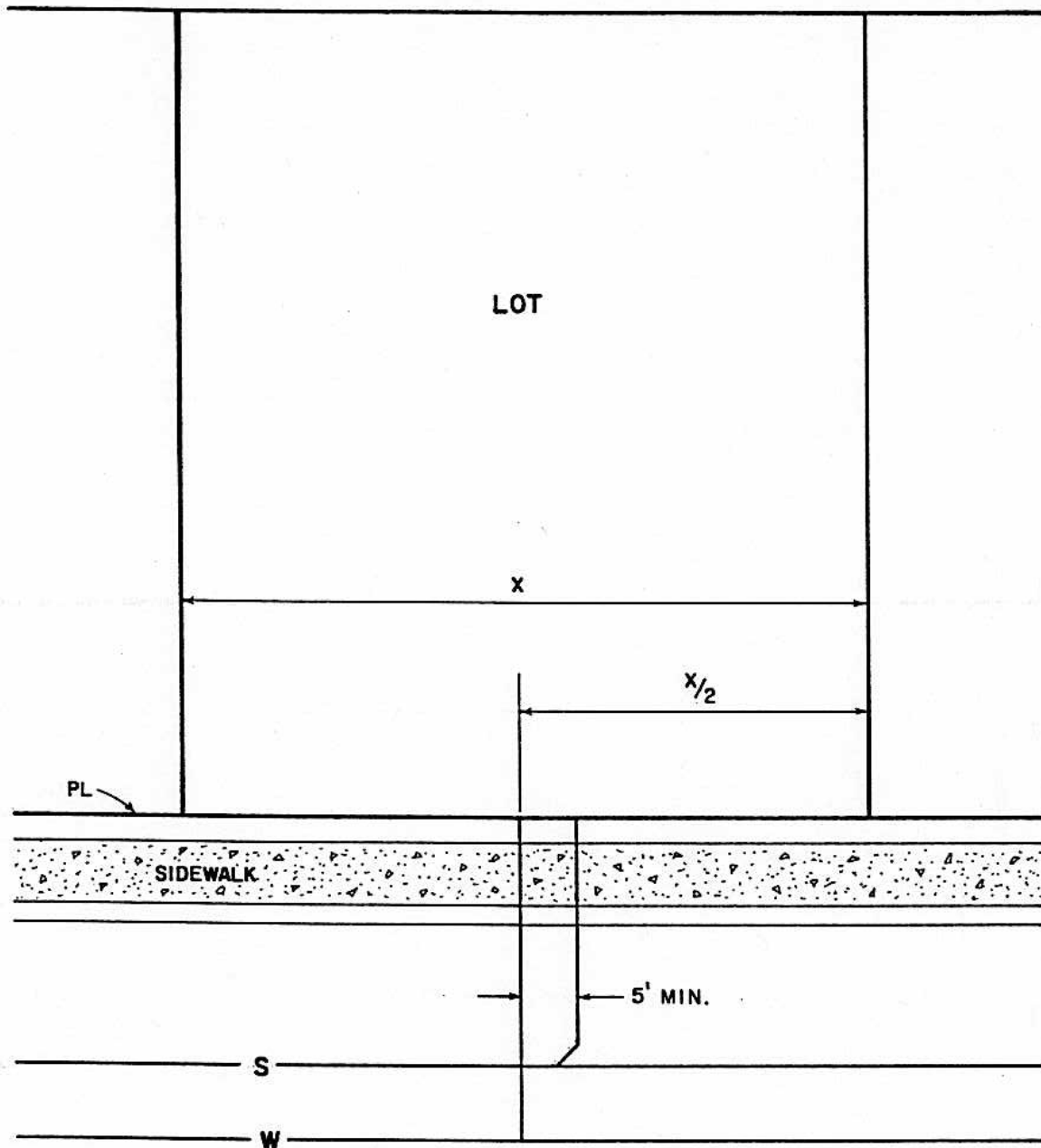

NOTES:

1. SEWER LATERALS MAY BE INSTALLED ON EITHER SIDE OF THE WATER CONNECTION.
2. SEWER AND WATER SERVICES AT THE END OF A CUL-DE-SAC MAY BE LOCATED NO CLOSER THAN 2 1/2 FEET FROM THE SIDE LOT LINE.

NO.	REVISED	BY	LOT UTILITY LAYOUT	APPROVED BY:	E-8
				<i>M. Brinton</i>	
DRAWN BY: J. KOESTER				DIRECTOR OF PUBLIC WORKS	
CHECKED BY: J. PODESTA				DRAWING NO.	
SCALE: NONE			CITY OF MANTECA	DATE: JAN. 1988	
			DEPARTMENT OF PUBLIC WORKS		

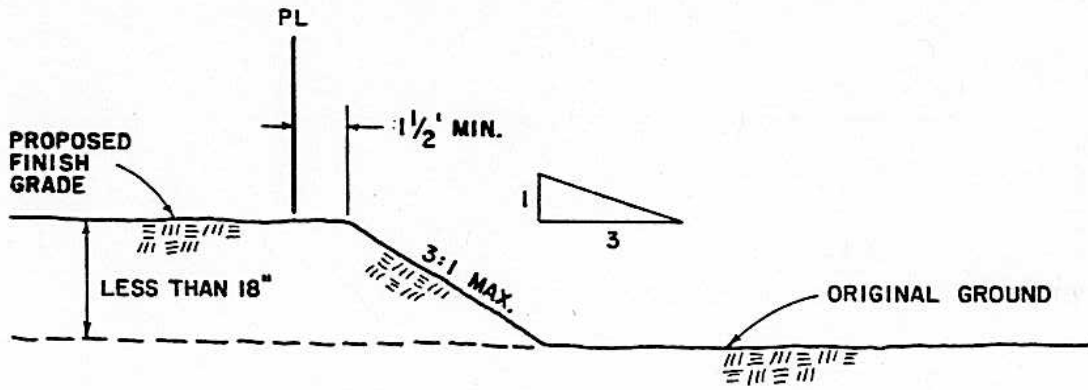

TO BE USED FOR LOT DIFFERENCE LESS THAN 18"

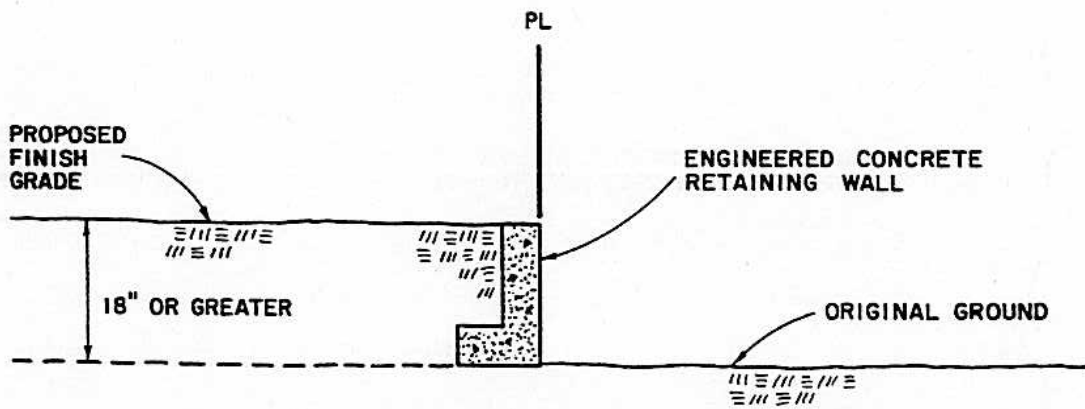

TO BE USED FOR LOT DIFFERENCE OF 18" OR GREATER

NOTES:

1. DETAILS AND CALCULATIONS FOR THE CONCRETE RETAINING WALL SHALL BE SUBMITTED TO THE PUBLIC WORKS DEPARTMENT FOR APPROVAL.

NO.	REVISED	BY	PROPERTY LINE RETAINING WALL	APPROVED BY:
DRAWN BY: J. KOESTER				<i>M. Brinton</i>
CHECKED BY: J. PODESTA				DIRECTOR OF PUBLIC WORKS
SCALE: NONE			CITY OF MANTECA	DRAWING NO. E-9
			DEPARTMENT OF PUBLIC WORKS	DATE: JAN. 1988